

# HI-LO 1979 TRAVEL TRAILERS floor plans

## BonVoyage

2879

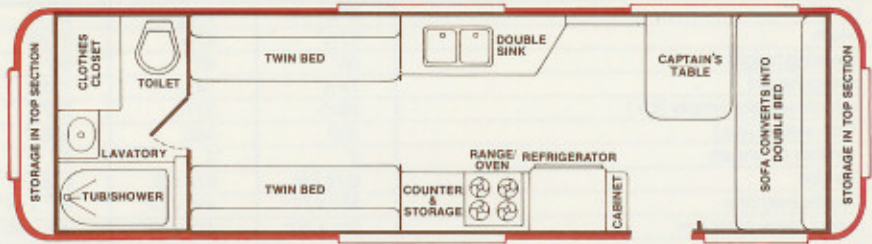

## Voyager

2579D

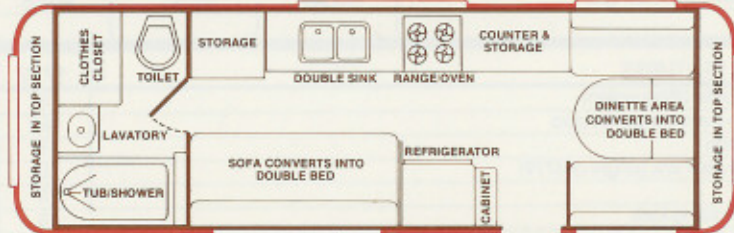

2579

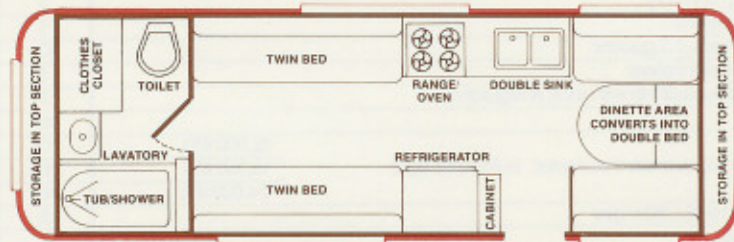

## FunChaser

2179T

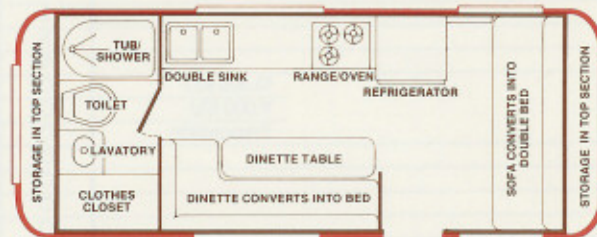

2179

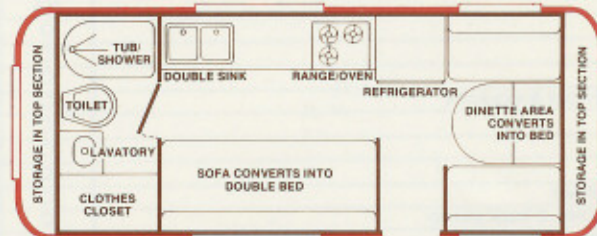

## FunMaker

1779

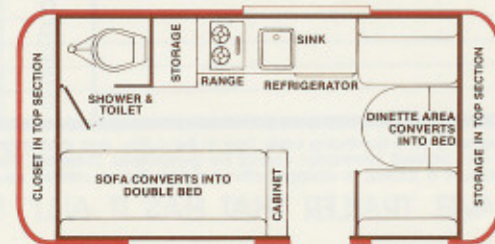



# 1979 TRAVEL TRAILERS specifications and features

SPECIFICATIONS	1779	2179	2179T	2579	2579D	2879
Length	17'8"	20'8"	20'8"	24'8"	24'8"	28'8"
Width	87 1/2"	87 1/2"	87 1/2"	91 1/2"	91 1/2"	91 1/2"
Traveling height	66"	65"	65"	71"	71"	71"
Interior height	74 1/2"	74 1/2"	74 1/2"	77 1/2"	77 1/2"	77 1/2"
Vehicle weight, empty (lbs.)	2365	2775	2775	3550	3550	4300
Hitch weight (lbs.)	300	385	385	450	450	525
Number of wheels	2	4	4	4	4	4
Tire size	G78 x14	B78 x13	B78 x13	G78 x14	G78 x14	G78 x14
Dinette bed size	38" x 77"	44" x 77"	42" x 74"	44" x 81"	44" x 81"	44" x 77" Sofa
Swing-away bunk size	36" x 80"	40" x 80"	40" x 80"	44" x 84"	44" x 84"	44" x 84"
Sofa	44" x 74"	44" x 74"	44" x 77"	30" x 74" (Twin)	44" x 74"	30" x 74" (Twin)
Sleeping capacity	4 to 5	4 to 6	4 to 6	4 to 6	4 to 6	4 to 6
Refrigerator; 3-way 12v/110v/gas	RM 36	RM 46	RM 46	RM 66	RM 66	RM 66

EQUIPMENT FEATURES		1779	2179	2179T	2579	2579D	2879
Automatic hydraulic lifting system		S	S	S	S	S	S
Brushed chrome oven/range & hood		NA	S	S	S	S	S
2-burner range top		S	NA	NA	NA	NA	NA
Double stainless steel sink (single on 1779)		S	S	S	S	S	S
Window drapes		S	S	S	S	S	S
Flush toilet with holding tank		S	S	S	S	S	S
Tub/shower combination (optional shower only on 1779)		O	S	S	S	S	S
2 Holding tanks (1 on 1779)		S	S	S	S	S	S
Demand water system		S	S	S	S	S	S
Water heater, LP gas, 6.3 gallons		O	S	S	S	S	S
30-gallon fresh water system		S	S	S	S	S	S
Gas bottles, LP double 20-lb with rack & regulator		S	S	S	S	S	S
Lavatory		NA	S	S	S	S	S
Furnace, forced air, ducted, thermostat, automatic light	12,000 BTU	O	NA	NA	NA	NA	NA
	16,000 BTU	NA	S	S	S	S	NA
	24,000 BTU	NA	NA	NA	NA	NA	S
Refrigerator, 3-way 12v/110v/gas		S	S	S	S	S	S
Skylight roof vents		S	S	S	S	S	S
Electric brakes, all wheels		S	S	S	S	S	S
12-volt lights		S	S	S	S	S	S
30-amp converter with charger		S	S	S	S	S	S
Breakaway switch		S	S	S	S	S	S
Battery, 12v, heavy duty 72 amp		S	S	S	S	S	S
Dinette table		S	S	S	S	S	S
Air Conditioner, roof	13,500 BTU	O	O	O	O	O	O
	11,000 BTU	O	O	O	O	O	O
	Preparation	O	O	O	O	O	O
Antenna, TV		O	O	O	O	O	O
Awning		O	O	O	O	O	O
Boat rack, roof		O	O	O	O	O	O
Bunk, swing-away, front		O	O	O	O	O	O
Bunk ladder		O	O	O	O	O	O
Carpeting, luxury		NA	NA	NA	O	O	S
Cover, 20-lb gas bottle, double		O	O	O	O	O	O
Cover, 30-lb gas bottle, double		O	O	O	O	O	O
Cover, spare tire		O	O	O	O	O	O
Gas bottles, LP double, 30-lb with rack & regulator		O	O	O	O	O	O
Hitch jack, power		O	O	O	O	O	O
Hose, 3" x 10', sewer		O	O	O	O	O	O
Jacks, leveling; set		O	O	O	O	O	O
Jacks, stabilizer, H.D., weld or bolt; set		O	O	O	O	O	O
Radio, push button AM/FM multiplex, 8-track stereo		O	O	O	O	O	O
Radio, AM/FM multiplex, cassette		O	O	O	O	O	O
Spare wheel & tire, 13"		NA	O	O	NA	NA	NA
Spare wheel & tire, 14"		O	NA	NA	O	O	O
Carrier, spare wheel		O	O	O	O	O	O
TV, 9", 3-way color		O	O	O	O	O	O
Vent, power roof		O	O	O	O	O	O
Valances, window		O	O	O	O	O	O
Travel awning		O	O	O	O	O	O

S - Standard  
O - Optional at  
Extra Cost

NA - Not Available

HI-LO makes product improvements on a continuing basis. Due to this policy, and to changes in specifications, design, production and availability of supplies, the accuracy of all written and pictorial information cannot be guaranteed. Therefore, the availability of certain models, floor plans, colors, materials and equipment shown in this brochure is subject to change without notice. Please contact your HI-LO dealer for current models, specifications and information.

**HI-LO, "THE TRAVEL TRAILER THAT HAS IT ALL!" See them at your dealer today.**



HI-LO TRAILER COMPANY  
100 Elm Street  
Butler, Ohio 44822  
(419) 883-3000